

<b>OUTLINE 3-PHASE INDUCTION MOTOR</b>	<b>TOTALLY ENCLOSED FAN COOLED SQUIRREL CAGE ROTOR ANTI-FRICTION BEARING</b>	<b>PROJECT NO:</b>
		<b>CUSTOMER: PO. NO: ORDER NO:</b>

OUTPUT	POLE	SYN. SPEED RPM.	VOLT. V.	FREQ HZ	INSUL. F	TIME RATING S1	MODEL TIK-FCKW	FRAME NO. N355LL
--------	------	--------------------	-------------	------------	-------------	-------------------	-------------------	---------------------

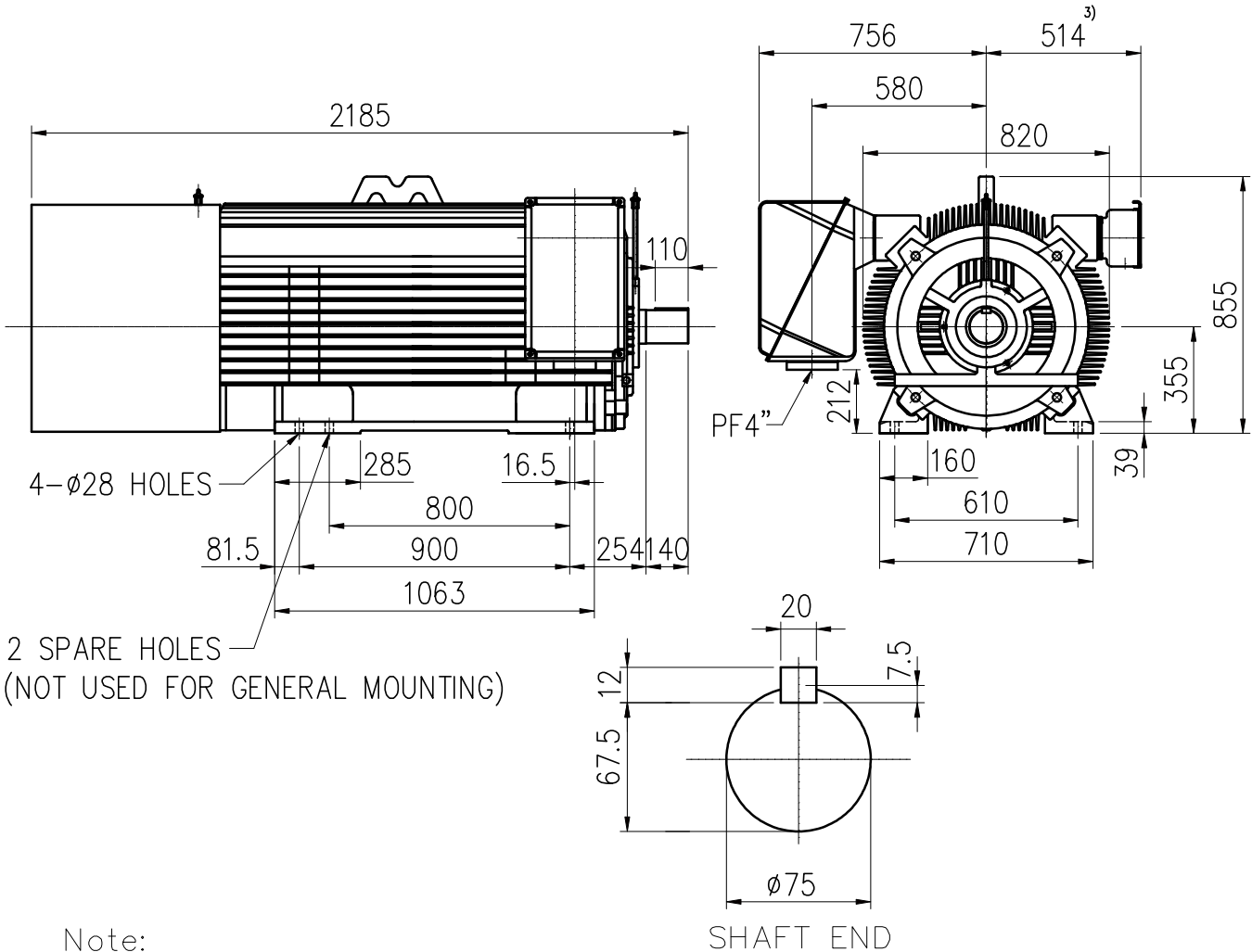

- Note:
- 1) Tolerance of shaft end diameter: m6
  - 2) Tolerance of shaft center height: +0 , -1.0
  - 3) Auxiliary terminal box is optional and dependent on specified accessories.
  - 4) For direct coupling.
  - 5) Approximate weight = 3000 kg
  - 6) Drive end bearing: 6218C3  
Opposite drive end bearing: 6218C3
  - 7) Direction of rotation : C.W (viewed from non-drive end)

Preliminary Drawing for Reference Only



BASIC DWG NO: AL-FB-5604

CERTIFIED BY:		DATE:
DESIGNED	C.Y.WEN	DIMENSIONS IN mm
CHECKED	T.F.CHENG	3RD ANGLE PROJECTION
APPROVED	T.F.CHENG	DATE: NOV.30.2009