

# OUTLINE 3-PHASE INDUCTION MOTOR

TOTALLY ENCLOSED FAN  
COOLED, SQUIRREL CAGE  
ROTOR (WMP-90)  
  
(OUTDOOR)

FILE NO:  
CUSTOMER:  
PO. NO:  
ORDER NO:

OUTPUT	POLE	SYN. SPEED R.P.M	VOLT. V	FREQ Hz	INSUL. F	TIME RATING S1	MODEL FHFC-HD	FRAME NO. 132SM
	2							

\*\* IE3 EFFICNECY  
\*\* FOR DIRECT COUPLING

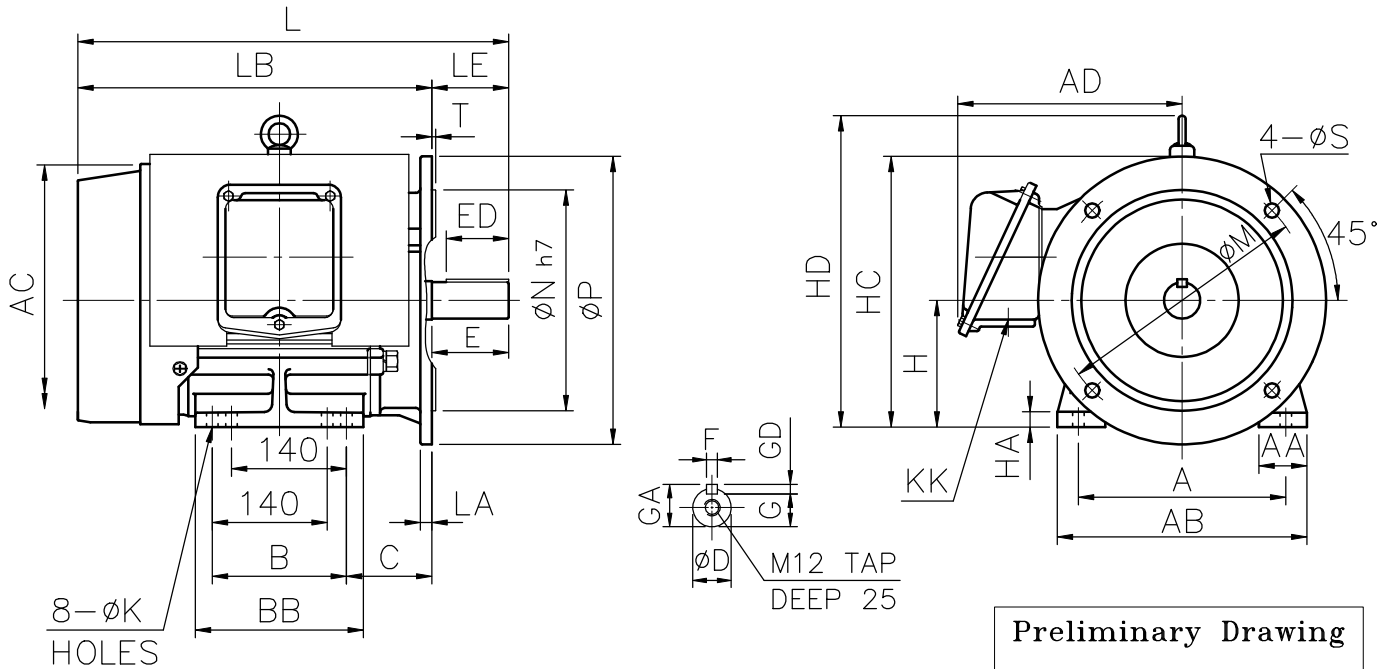

Preliminary Drawing  
For Reference Only

A	B	C	H	φK	L	AA	AB	φAC	AD	LB	LE	BB	HA	HD	HC	KK
216	178	89	132	12	488	50	260	286	236	408	80	213	15	316	274	PF1"

φM	φN	φP	φS	T	LA	SHAFT END							BEARING NO.		APPROX WEIGHT
						φD	E	ED	F	G	GD	GA	D.E	O.D.E	
265	230	300	14.5	4	12	38	80	65	10	33	8	41	6308zz	6208zz	89kg

NOTE: 1. TOLERANCE OF SHAFT END DIAMETER D: k6 (+0.018 , +0.002)  
2. TOLERANCE OF SHAFT CENTER HEIGHT H: +0 , -0.5



CERTIFIED BY : _____		DATE : _____	
DESIGNED	S.L.Tsai Mar.26.2019	DWG. NO:	AS-080584
CHECKED	L.J.Lee Mar.26.2019	3RD ANGLE PROJECTION	
APPROVED	L.J.Lee Mar.26.2019	DIMENSIONS IN mm	